



KNIFE-GATE VALVES

L SERIES

HYDRAULIC ACTUATOR (Oil pressure: 135 Kg/cm²)

- **A = Max. width** of the valve (without actuator).
- **B = Max. height** of the valve (without actuator).
- **C = maximum length** when the gate is centred.
- The hydraulic actuator includes:
 - Hydraulic cylinder.
 - Yoke.
- Available: ND50 to ND2000.
- Different types and brands available according to customer's requirements.
- The weights are approximate and vary according to the material and the valve's accessories.

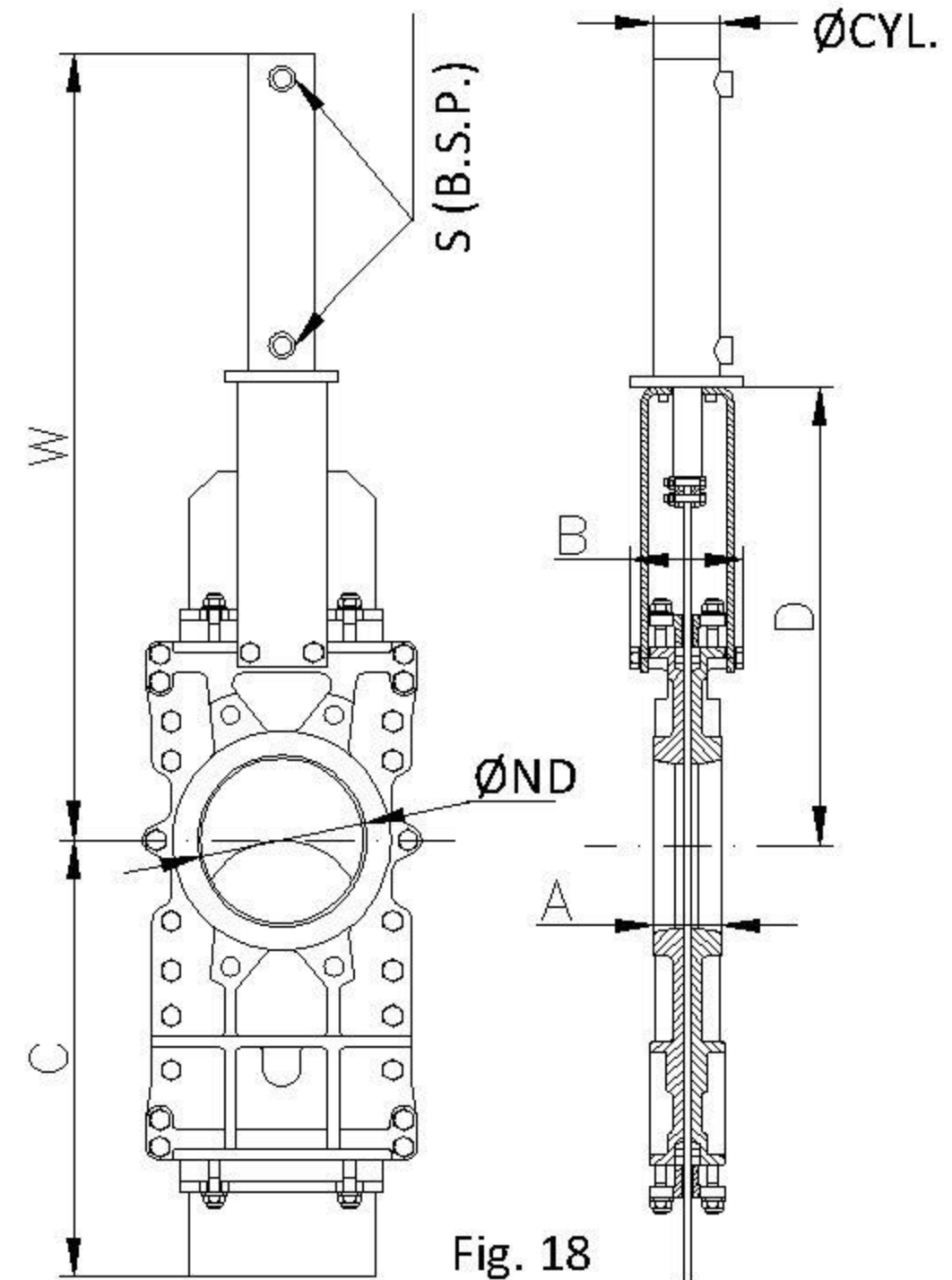

Fig. 18

ND	ΔP (Kg/cm ²)	DRAW (Nw)	A	B	C	D	W	Ø CYL.	Ø ROD	S (B.S.P.)	Oil Cap. (dm ³)	Weight (kg.)
50	10	894	40	91	225	243	459	25	18	3/8"	0.03	17
65	10	1508	40	91	265	269	500	25	18	3/8"	0.03	18
80	10	2281	50	91	310	293	559	25	18	3/8"	0.04	22
100	10	3561	50	91	370	334	620	32	22	3/8"	0.09	24
125	10	5565	50	101	430	367	683	32	22	3/8"	0.11	33
150	10	6419	60	101	495	419	755	40	28	3/8"	0.20	43
200	8	10020	60	118	630	525	927	50	28	3/8"	0.42	61
250	6	11230	70	118	770	620	1071	50	28	3/8"	0.52	99
300	6	16210	70	118	895	726	1223	50	28	3/8"	0.62	131
350	5	17740	96	290	1050	780	1360	50	28	3/8"	0.73	182
400	5	23260	100	290	1185	855	1484	63	36	3/8"	1.31	254
450	3	22260	106	290	1320	975	1693	63	36	3/8"	1.47	387
500	3	27470	110	290	1455	1064	1832	63	36	3/8"	1.62	498
600	3	39850	110	290	1720	1244	2111	80	45	3/8"	3.12	559
700	2	36880	110	320	1995	1425	2444	80	45	3/8"	3.62	983
800	2	48980	110	320	2230	1615	2734	100	56	1/2"	6.44	N.G.
900	2	61230	110	320	2465	1823	3042	100	56	1/2"	7.25	N.G.
1000	2	77690	110	320	2620	1992	3351	125	70	1/2"	10.25	N.G.
1100	2	95506	150	340	3030	2217	3560	125	70	1/2"	13.56	N.G.
1200	2	113710	150	340	3250	2351	3910	125	70	1/2"	15.05	N.G.
1300	2	133563	150	390	3430	2882	4477	160	70	1/2"	26.3	N.G.
1400	2	157280	150	390	3680	3250	4945	160	70	1/2"	28.65	N.G.
1500	2	180712	170	426	3930	3517	5354	160	70	1/2"	30.7	N.G.
1600	2	205780	170	426	4272	3775	5712	160	70	1/2"	32.7	N.G.
1700	2	236498	190	440	4615	4008	6045	200	90	1/2"	53.72	N.G.
1800	2	264860	190	440	4886	4242	6379	200	90	1/2"	57.35	N.G.
1900	2	299502	210	480	5158	4390	6668	200	90	1/2"	60.16	N.G.
2000	2	331260	210	480	5430	4540	6918	200	90	1/2"	63.65	N.G.

N.G.: Weight not given

table 11